

QUICK REFERENCE GUIDE: T/PUMP® (TP700 AND TP700C)

C2Dx®

1. Attach pad(s) to the permanently connected T/Pump® hose. *(See Figure 1.)* Pads with Clik-Tite® connectors can be interconnected. *(See Figure 2.)*
2. **Fill with tap water:** For warming therapy fill to ☹️. For cooling therapy fill to ❄️ then fill remainder of reservoir with ice. *(See Figure 3.)*
3. **Turn on the unit:** Press the On/Standby button (F). *(See Figure 4.)* The Green Light (E) indicates that unit is ON. The Yellow Light (G) indicates that the machine has power and is in Standby mode.
4. **Set Therapy Time.** Toggle button (D) to prescribed therapy timing. Ensure you are checking patient's skin condition every 20 minutes.
5. **Set Temperature:** Toggle Temperature button (C) to the prescribed temperature setting. Light will flash until unit reaches temperature.
6. Turn Off when therapy is complete by pressing the On/Standby button (F). The Yellow Light (G) will remain on as long as the unit is plugged in and indicates that the unit is in Standby mode. Allow the water to drain back into the unit for a few moments, then disconnect the pad(s) from the hose.

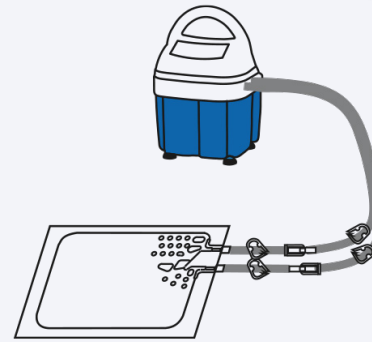

Figure 1

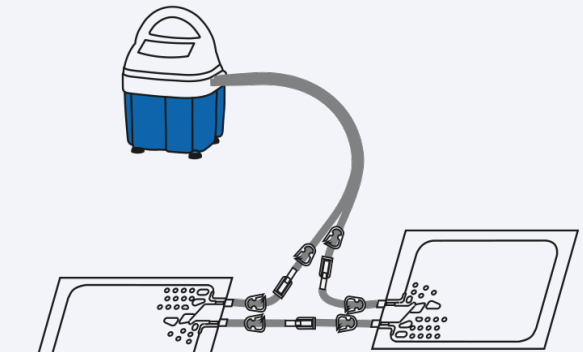

Figure 2



Figure 3

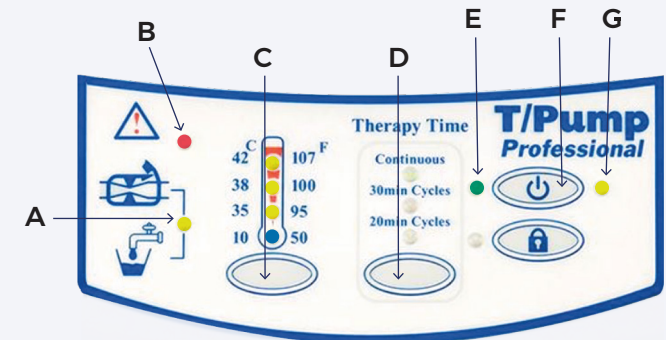

Figure 4

NOTE: If Warning light (B) lights, see list of Cautions in manual. If Warning light (A) lights, check for kinks in the hoses or inadequate water level. See manual for Indications for Use, Warnings/Cautions.

For more information, please contact Customer Service at **888-902-C2DX (2239)** or **c2dx@c2dx.com**
www.c2dx.com/manuals