

# Extract salivary stones.

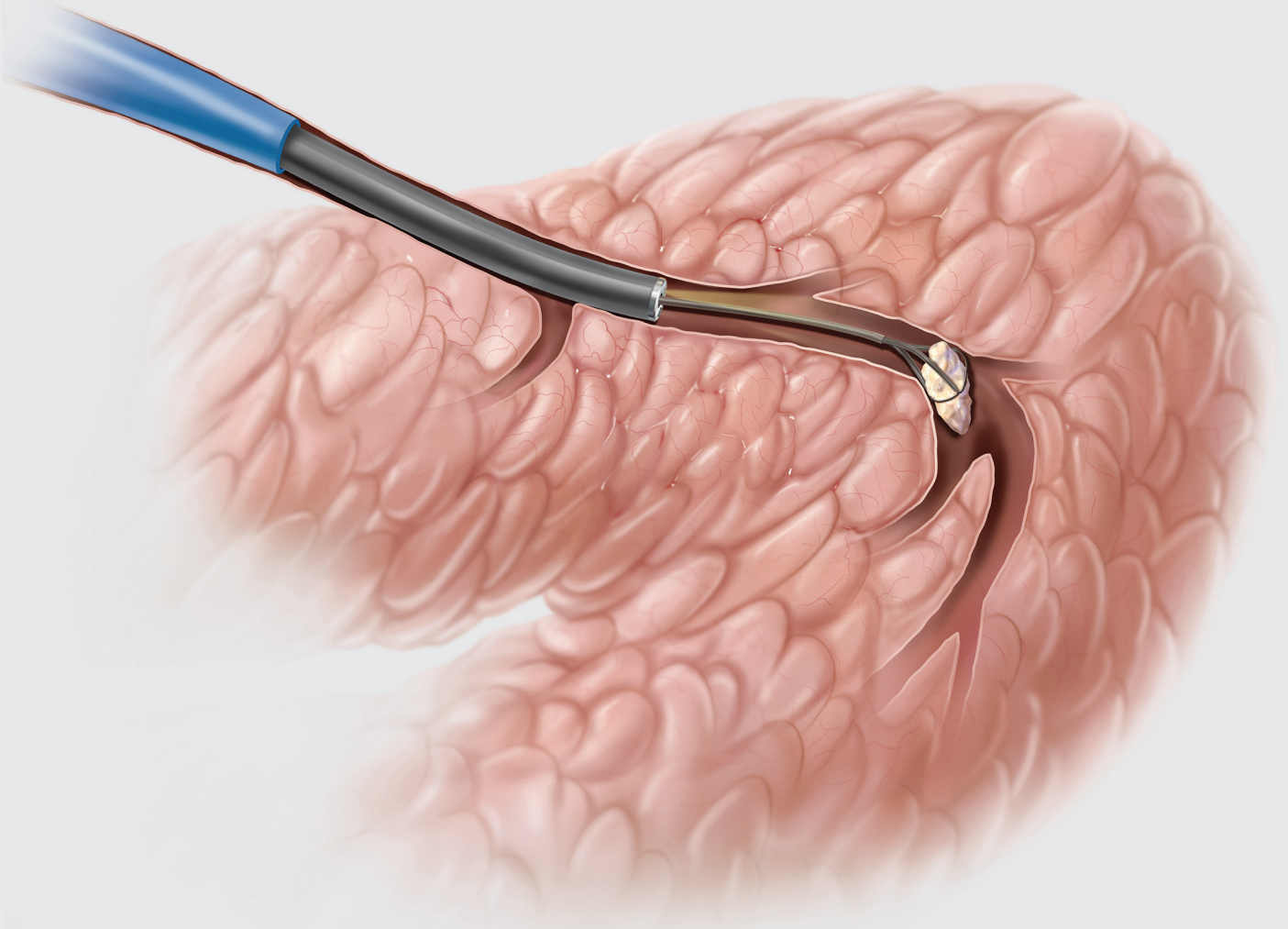

Illustration by Lisa Clark

## NGage<sup>®</sup> SALIVARY STONE EXTRACTOR

### Dual performance

The stone extractor can hold stones like a basket and release them like a grasper, providing optimized control throughout the entire procedure.

### Ergonomic

The handle is easy to use and allows you to deploy the stone extractor single-handedly.

### Durable

The stone extractor's nitinol material is flexible and kink resistant.



# NGage®

## SALIVARY STONE EXTRACTOR

Used for manipulation, entrapment and extraction of calculi and other foreign bodies in the salivary ducts, and to minimize migration of salivary stones during interventional procedures.

Order Number	Reference Part Number	Catheter Fr	Catheter Length cm	Basket Diameter mm
G23798	SSEB-1.7-115-8	1.7	115	8

## Related products

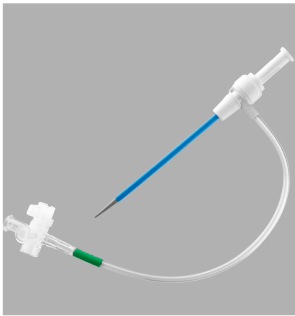

### Kolenda Salivary Access Introducer Set

Used for the introduction of diagnostic or interventional devices in the submandibular salivary duct.

Order Number	Reference Part Number	Introducer ID mm/inch	Wire Guide Diameter inch	Sheath Length cm
G24129	SDAS-6.0-18	2.2/087	.018	5.5
G24132	SDAS-5.0-18	1.9/074	.018	5.5

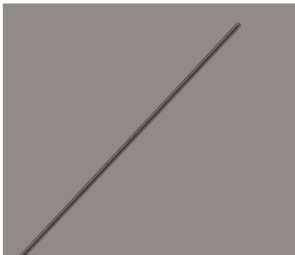

### Wire guides

Used to gain and maintain access to the salivary duct.

Order Number	Reference Part Number	Wire Guide Diameter inch	Wire Guide Length cm	Tip Configuration
G02274	C-SF-15-50	.015	50	Straight

Some products or part numbers may not be available in all markets. Contact your local C2Dx sales representative or Customer Service for details.



\* Copyright© 2024 C2Dx  
 \* Printed in U.S.A.  
 \* 555 East Eliza St, Ste. A  
 Schoolcraft, MI 49087 USA  
 \* t: 888 902 2239  
 www.c2dx.com